

Technical Data



Engine

RL 855
Make DEUTZ
Type BF4L 2011
Performance 50 kW (68hp) at 2,300 rpm.
Cylinders / stroke volume 4 in line/ 3.108 ltrs.
Cooling system oil / air

Engine

RL 655
Type F4L 2011
Performance 42kW (58hp) at 2,300 rpm.
Cylinders / stroke volume 4 in line/ 3.108 ltrs.
Cooling system oil / air

Waste gas values acc. to 97/68/EC; stage II.
Dry air filter with safety cartridge and pollution indicator.



Drive Unit

power-controlled hydrostatic drive unit with maximum-load control, i.e. automatic adaptation of traction power and speed; creep speed gearshift via rotary potentiometer steadily adjustable 0 - 20 km/h travelling speed can be reduced at full engine revolutions; via an inch/brake pedal, giving at the same time more power to the working hydraulics operating ranges shiftable under load

Front axle: planetary rigid axle with multiple-disc self-locking differential, rigid mounted planetary rigid axle with reduction gear, swingingly suspended with multiple-disc self-locking differential and multiple-disc brake, rear axle oscillation +/- 12°.

Rear axle: planetary rigid axle with multiple-disc self-locking differential, rigid mounted planetary rigid axle with reduction gear, swingingly suspended with multiple-disc self-locking differential and multiple-disc brake, rear axle oscillation +/- 12°.

Working operation: 0 - 7 km/h
max. traction power / limited speed

Road operation: 0 - 20 km/h
max. traction power / limited speed

Option: 0 - 25 km/h high-speed version
as another option 38 km/h



Brakes

Service Brake
hydraulic foot-operated brake actuating two oil-immersed multiple-disc brakes effective on all 4 wheels via the all-wheel drive hydrostatic drive unit acting as wear-resistant auxiliary service brake

Parking Brake
mechanical operation of multiple-disc brake



Tires

	RL 855	RL 655
Front and rear	405/70 R 20 MPT 01	12.5-20 R20 MPT 04
Option	405/70 R 20 EM 01	405/70 R20 MPT 01

Special tires on request.



Steering

Articulated steering, fully hydraulic via priority valve, quick and easy steering even at idling speed.
Total steering angle 80°.
In case of non-running engine, emergency steering characteristics of the wheel loader are provided.



Loading System

Hydraulic quick-change device as standard.
Sealed bearings with prolonged lubrication intervals.
Z-kinematics for high breaking force and quick dumping out.



Filling Capacities

Diesel fuel: 80 l
Hydraulic system: 65 l



Hydraulic System

Working / Steering hydraulic, pump discharge
RL 855 max. 76 l/min.; **RL 655** max. 60 l/min.
Working pressure, loading / steering hydraulics 200 bar/ 180 bar
Lifting and tipping cylinder double acting.

Control unit with electro-hydraulic anticipatory control proportionally load-independent.

Control block with 3 operating circuits.
Single-lever cross-type control for lifting and tipping cylinders and additional control circuit for quick-change device and attachments; it is possible to switch on floating position.



Dimensions and Weights

RL 855 acc. to drawing RL 655 acc. to drawing
Operating weight 5,400 kg Operating weight 4,700 kg



Electrical Equipment

Generator, three-phase current 14 V/ 60 A
Starter 2.2 kW/ 12 V
Battery 12 V/ 88 Ah
Battery voltage 12 V
Lighting acc. to StVZO (German Motor Vehicle Construction and Use Regulations) with halogen headlights.



Noise Emission Level

Guaranteed noise level: acc. to directive 2000/14/EC

Cabin

Standard Equipment

large, elastically supported cabin (ROPS-FOPS) granting all-round view, with plane entrance on both sides; parallel windshield wiper in front and rear with "parking position" and windshield washer, interval mechanism for wiper in front; tinted safety glazing, rounded panoramic front and rear window, sliding window on the right; fully adjustable, ergonomic comfortable driver's seat with disc support, safety belt; steering wheel and instruments console adjustable as to inclination and height; adjustable engine oil heating with defrosting nozzles for front and rear window, 3-stage ventilator for fresh air and warm air; service hour meter, fuel indicator and all other necessary operating, controlling and indicating instruments clearly arranged on the instrument board; 12 V plug socket; commutator switch and switch for additional control circuit integrated in the joystick, joystick moving together with the seat; 1-key system, interior lamp, sun shield, inside mirror, battery main switch; folding outside mirror on both sides, 2 working headlights in front of the cabin

Special Equipment

Options:

heated outside mirrors electrically adjustable;
working headlight in the back of the cabin;
panoramic lamp; acoustic reversing signal;
radio, air conditioning plant, anti-theft device;
comfortable driver's seat with pneumatic cushioning;
central lubrication system, pre-filter for coarse-grained dust, safety device against pipe breakage;
pressureless return pipe in front, additional control circuit for attachments; shock absorption system for loading system;
first filling with biological oil, protective paint against aggressive agents;
soot filter system, spare wheel, catalyzer;
universal shovel, lifting fork, load hook, power sweeper, snowplow, etc.

Other options on request

Powerful - productive - universal



PAUS
...the people who care!

RL 655 + RL 855



Articulated loader RL 655 + RL 855

Efficient wheel loader for universal tasks.

PAUS
...the people who care!

Hermann Paus Maschinenfabrik GmbH
Siemensstraße 1-9 · 48488 Emsbüren
Telefon: (0 59 03) 7 07 - 0
Telefax: (0 59 03) 7 07 - 33
info@paus.de
www.paus.de

your distributor:



Z-kinematics: two lifting cylinders provide high lifting forces during operation of bucket



Excellent payload during operation as a forklift combined with an optimum parallel guidance



Extremely good accessibility for inspection and maintenance works due to the GFK engine cover that can be opened widely



Plain entrance on both sides, control device foldable to the back, ergonomically designed joystick, orthopaedic comfortable seat with safety belt and disc support



Electro-hydraulic anticipatory control via multifunctional joystick

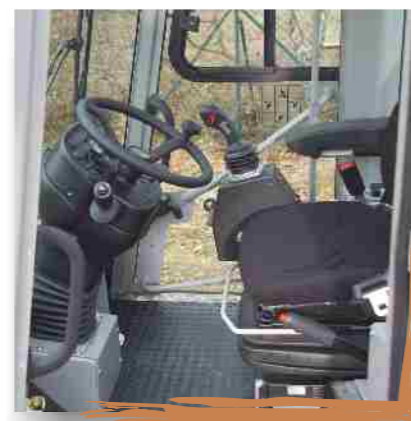

Comfortable cabin with fully adjustable steering column and very good panoramic view



Additional connection for hydraulic attachments, e.g. concrete-mixing bucket or power sweeper



A PAUS standard: hydraulic quick-change device for many attachments



The central bar close to the steps allows easy lubrication of the complete chassis

PAUS -Wheel Loaders RL 655 / RL 855

...the people who care

have always been up-to-date and pointing the way to the future. Besides a functional and modern visual effect, superior performance, unmatched versatility and extreme efficiency combined with high operating comfort were to priority for the new series -55.

Distinguishing features of Paus Articulated Loaders:

- With Paus Articulated Loaders RL 655 and RL 855 you may dispose of efficient, compact all-wheel driven wheel loaders. With the series -55, Paus offers modern design combined with superior technology. The cabin provides an excellent panoramic view. Large windows allow best view to bucket, wheels and attachments which has a positive effect on safety.
- Paus offers very good air conditioning of the cabin, heating of the feet compartment, defroster nozzles for front and rear windows via 3-stage blower; and as option: air conditioning plant and comfortable seat with air suspension.
- High breaking forces and quick emptying of bucket due to Z-kinematics with optimum parallel guidance for the handling of pallets. All attachments as of series -51 are suitable for the series -55.
- Easy operation of the loader via multifunctional joystick so that the driver can fully concentrate on his work; this supports the productivity of the machine.

- Articulated joint with pendulum axle; by this, the entire weight of the wheel loader is always at the bucket resulting in a particularly good prospecting mark.

- Fully developed technology meets all valid regulations as to noise protection and safety.



RL 655 / RL 855

A machine for all kinds of application in structural and civil engineering, landscaping and agricultural and municipal work.

The manifold details you find in the Paus Articulated Loader make it one of the best in its performance class.

Technical Data

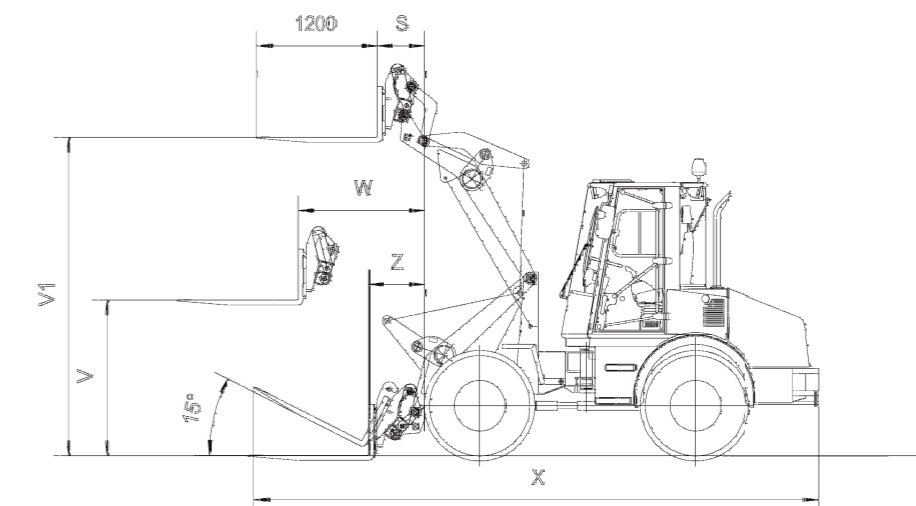
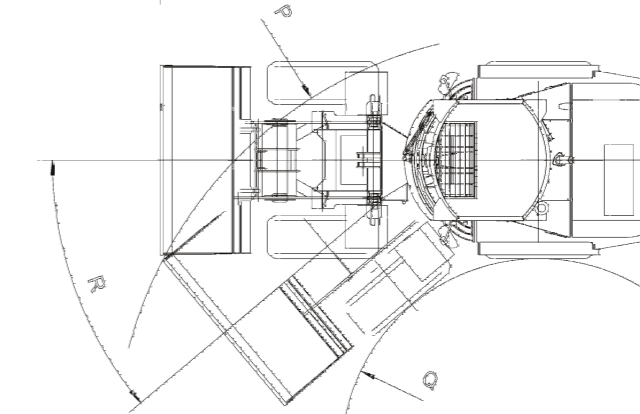
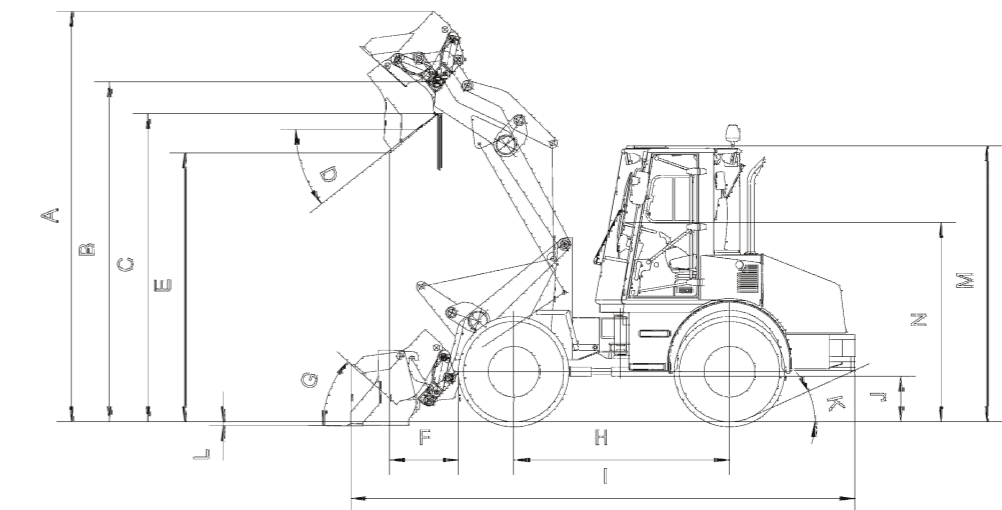

RL	655	855
A	4077	4220
B	3378	3482
B1		
C	3062	3194
C1		
D	38°	41°
D1		
E	2672	2680
E1		
F	683	846
F1		
F2		
F3		
G	42°	44°
H	2145	2170
I	5003	5138
J	445	445
K	24°	24°
L	40	117
M	2742	2742
N	1980	1980
O	1850	1950
P	R4216	R4352
Q	R2010	R2000
R	40°	40°
S	470	592
S1		
T		
U		
V	1549	1480
V1	3166	3280
V2		
W	1258	1345
W1		
X	5634	5697
Y		
Z	555	593
AA		
AA1		
BB		
CC		
CC1		

Operating Data	RL 855	RL 655
Bucket capacity	1,0 m ³	0,8 m ³
Width of bucket	2000 mm	1850 mm
Width of loader	1900 mm	1800 mm
Breaking force	59 KN	56 KN
Tipping load, articulated	3800 Kg	3300 Kg
Lifting force on the ground	58 KN	46 KN
Operating weight	5400 Kg	4700 Kg
<i>Data with lifting fork</i>		
payload acc. to EN 474-3		
Payload 80 %, transport position/articulated	2600/ 2380 Kg	2360/ 2000 Kg
Payload 60 %, transport position/articulated	2360/ 2100 Kg	2100/ 1760 Kg

All specifications without engagement. Our machines correspond to the latest European Safety Directives. We reserve the right to effect changes in design!